

SELEZIONE OLEODINAMICA

TUBI E RACCORDI A PRESSARE



Flessibili media pressione

- Rivestimento in caucciù resistente all'olio
- Temperatura da -40°C a +100°C
- Non contiene alogeni

Flessibili 1 treccia NST-HF

Norma SAE100R1AT e EN853-1SN



1 treccia acciaio				Boccola
Ø int (poll)	DN	Pressione (bar)	Cod.	Cod.
3/16	5	250	NSTHF5	SFAD105
1/4	6	225	NSTHF6	SFAD106
5/16	8	215	NSTHF8	SFAD108
3/8	10	180	NSTHF10	SFAD110
1/2	13	160	NSTHF13	SFAD113
5/8	16	130	NSTHF16	SFAD116
3/4	19	105	NSTHF20	SFAD120
1"	25	88	NSTHF25	SFAD125
1"1/4	32	63	NSTHF32	SFAD132
1"1/2	40	50	NSTHF40	SFAD140

Flessibili 2 trecce HST-HF

Norma SAE100R2AT e EN853-2SN



2 trecce acciaio				Boccola
Ø int (poll)	DN	Pressione (bar)	Cod.	Cod.
3/16	5	420	HSTHF5	SFAD205
1/4	6	400	HSTHF6	SFAD206
5/16	8	350	HSTHF8	SFAD208
3/8	10	330	HSTHF10	SFAD210
1/2	13	275	HSTHF13	SFAD213
5/8	16	250	HSTHF16	SFAD216
3/4	19	215	HSTHF20	SFAD220
1"	25	165	HSTHF25	SFAD225
1"1/4	32	125	HSTHF32	SFAD232
1"1/2	40	90	HSTHF40	SFAD240
2"	50	80	HSTHF50	SFAD250

Flessibili 1 treccia NSK-Compact

Norma EN857-1SC



1 treccia acciaio				Boccola
Ø int (poll)	DN	Pressione (bar)	Cod.	Cod.
1/4	6	225	NSK6	SFAR1706
5/16	8	215	NSK8	SFAR1708
3/8	10	210	NSK10	SFAR1710
1/2	13	210	NSK13	SFAR1713

Flessibili 2 trecce HSK-HF-Compact

Norma EN857-2SC



2 trecce acciaio				Boccola
Ø int (poll)	DN	Pressione (bar)	Cod.	Cod.
1/4	6	400	HSKHF6	SFAD106
5/16	8	350	HSKHF8	SFAD108
3/8	10	330	HSKHF10	SFAD110
1/2	13	275	HSKHF13	SFAD113
5/8	16	250	HSKHF16	SFAD116
3/4	19	215	HSKHF20	SFAD120
1"	25	165	HSKHF25	SFAD125

Flessibili 2 trecce HSK-PQ

Superiore a norma EN857-2SC



2 trecce acciaio				Boccola
Ø int (poll)	DN	Pressione (bar)	Cod.	Cod.
1/4	6	420	HSKPQ6	SFAD106
5/16	8	400	HSKPQ8	SFAD108
3/8	10	350	HSKPQ10	SFAD110
1/2	13	310	HSKPQ13	SFAD113
5/8	16	280	HSKPQ16	SFAD116
3/4	19	240	HSKPQ20	SFAD120
1"	25	210	HSKPQ25	SFAD125
1"1/4	32	145	HSKPQ32	SFA1S32
1"1/2	40	125	HSKPQ40	SFA1S40
2"	50	100	HSKPQ50	SFA14S50

Flessibili 2 trecce Super-Tuff HSK-ST

Rivestimento esterno estremamente resistente (resistenza all'usura 500 volte superiore ai flessibili compact standard)



2 trecce acciaio				Boccola
Ø int (poll)	DN	Pressione (bar)	Cod.	Cod.
1/4	6	400	HSKST6	SFAD106
5/16	8	375	HSKST8	SFAD108
3/8	10	350	HSKST10	SFAD110
1/2	13	310	HSKST13	SFAD113
5/8	16	280	HSKST16	SFAD116
3/4	19	240	HSKST20	SFAD120
1"	25	210	HSKST25	SFAD125

Bobine tubo flessibile

1 treccia NST-HF

1 treccia acciaio				
Ø int (poll)	DN	Pressione (bar)	Lung. (m)	Cod.
1/4	6	225	25	NSTHF6P025
1/4	6	225	50	NSTHF6P050
5/16	8	215	25	NSTHF8P025
5/16	8	215	50	NSTHF8P050
3/8	10	180	25	NSTHF10P025
3/8	10	180	50	NSTHF10P050
1/2	13	160	25	NSTHF13P025
1/2	13	160	50	NSTHF13P050



2 trecce HST-HF

2 trecce acciaio				
Ø int (poll)	DN	Pressione (bar)	Lung. (m)	Cod.
3/6	5	420	50	HSTHF5P050
1/4	6	400	25	HSTHF6P025
1/4	6	400	50	HSTHF6P050
5/16	8	350	25	HSTHF8P025
5/16	8	350	50	HSTHF8P050
3/8	10	330	25	HSTHF10P025
3/8	10	330	50	HSTHF10P050
1/2	13	275	25	HSTHF13P025
1/2	13	275	40	HSTHF13P040
1/2	13	275	50	HSTHF13P050
5/8	16	250	25	HSTHF16P025
3/4	19	215	25	HSTHF20P025

2 trecce compact HKS-HF

2 trecce acciaio compact				
Ø int (poll)	DN	Pressione (bar)	Lung. (m)	Cod.
1/4	6	400	25	HSKHF6P025
1/4	6	400	50	HSKHF6P050
5/16	8	350	25	HSKHF8P025
5/16	8	350	50	HSKHF8P050
3/8	10	330	25	HSKHF10P025
3/8	10	330	50	HSKHF10P050
1/2	13	275	25	HSKHF13P025
1/2	13	275	50	HSKHF13P050
5/8	16	230	25	HSKHF16P025

2 trecce HSK-PQ

2 trecce acciaio				
Ø int (poll)	DN	Pressione (bar)	Lung. (m)	Cod.
5/16	8	400	50	HSKPQ8P050R
3/8	10	350	50	HSKPQ10P050R
1/2	13	310	50	HSKPQ13P050R

2 trecce Super-Tuff HSK-ST

2 trecce acciaio				
Ø int (poll)	DN	Pressione (bar)	Lung. (m)	Cod.
1/4	6	400	50	HSKST650
5/16	8	375	50	HSKST850
3/8	10	350	50	HSKST1050
1/2	13	310	50	HSKST1350

Flessibili alta pressione

- Rivestimento in caucciù resistente all'olio e usura
- Temperatura da -40°C a +100°C
- Rinforzo con 4 spirali in metallo



Flessibili 4 trecce HDR

Norma EN856-4SP

4 trecce acciaio				Boccola
Ø int (poll)	DN	Pressione (bar)	Cod.	Cod.
1/4	6	450	HDR6	SFA4S06
3/8	10	445	HDR10	SFA4S10
1/2	13	415	HDR13	SFA4S13
5/8	16	350	HDR16	SFA4S16
3/4	19	380	HDR20	SFA4S20
1"	25	320	HDR25	SFA14S25

Flessibili 4 trecce 4SH

Norma EN856-4SH

4 trecce acciaio				Boccola
Ø int (poll)	DN	Pressione (bar)	Cod.	Cod.
3/4	19	420	4SH20	SFA4H20
1"	25	380	4SH25	SFA4H25
1"1/4	32	350	4SH32	SFA4H32
1"1/2	40	290	4SH40	SFA4H40

Flessibili per pulizia alta pressione

- Per applicazioni con acqua fredda o calda
- Rivestimento esterno liscio in caucciù sintético, resistente a usura, olio e ozono

Flessibili 1 treccia

Acqua calda max 155°C



1 treccia acciaio				Boccola
Ø int (poll)	DN	Pressione (bar)	Cod.	Cod.
1/4	6	210	SL301006	SFAR1706
5/16	8	210	SL301008	SFAR1708
3/8	10	210	SL301010	SFAR1710
1/2	13	210	SL301013	SFAR1713

Flessibili 2 trecce

Acqua calda max 155°C



2 trecce acciaio				Boccola
Ø int (poll)	DN	Pressione (bar)	Cod.	Cod.
1/4	6	210	SL302006	SFAR1706
5/16	8	210	SL302008	SFAR1708
3/8	10	210	SL302010	SFAR1710
1/2	13	210	SL302013	SFAR1713

Flessibili in PVC

- Conformi a norma SAE 100 R8
- Rivestimento in poliuretano termoplastico microperforato, resistente a intemperie, olio, abrasione e ozono
- Temperatura da -40°C a +100°C

Flessibili

Norma SAE 100 R8 e EN855-R8



1 treccia acciaio				Boccola
Ø int (poll)	DN	Pressione (bar)	Cod.	Cod.
3/16	5	340	CR85	SF1K05
1/4	6	310	CR86	SF1K06
5/16	8	250	CR88	SF1K08
3/8	10	240	CR810	SF1K10
1/2	13	185	CR813	SF1K13
5/8	16	140	CR816	SF1K16

Flessibili doppi

Norme SAE 100 R8 e EN855-R8



1 treccia acciaio				Boccola
Ø int (poll)	DN	Pressione (bar)	Cod.	Cod.
1/4	6	310	CR866	SF1K06
5/16	8	250	CR888	SF1K08
3/8	10	240	CR81010	SF1K10
1/2	13	185	CR81313	SF1K13

Guaine di protezione

Guaine in polietilene

- Protezione da usura
- Resistente a UV, olio e acidi
- Temperatura da -30° a +80°C



Ø int (mm)	Nero al m	Nero in bobina	Giallo al m	Giallo in bobina
10	KBV10Z	KBV10ZP025	KBV10G	KBV10GP025
13	KBV13Z	KBV13ZP025	KBV13G	KBV13GP025
16	KBV16Z	KBV16ZP025	KBV16G	KBV16GP025
20	KBV20Z	KBV20ZP025	KBV20G	KBV20GP025
26	KBV26Z	KBV26ZP025	KBV26G	KBV26GP025
35	KBV35Z	KBV35ZP025	KBV35G	KBV35GP025
42	KBV42Z	KBV42ZP025	KBV42G	KBV42GP025
55	KBV55Z		KBV55G	
65	KBV65Z		KBV65G	
80	KBV80Z		KBV80G	
100	KBV100Z		KBV100G	
125	KBV125Z		KBV125G	

Guaine in tessuto in polipropilene

- Protezione per cavi e tubi
- Conforme a EN 12999 e EN ISO 3457
- Resistente
- Riciclabile
- Resistente a UV, olio e acidi
- Temperatura da -40° a +80°C



Ø int (mm)	Cod.	Ø int (mm)	Cod.
17	SLRD17	46	SLRD46
23	SLRD23	55	SLRD55
27	SLRD27	62	SLRD62
30	SLRD30	78	SLRD78
36	SLRD36	109	SLRD109
39	SLRD39		

Telai avvolgitubi

- In acciaio zincato
- Consegnati senza bobine



Tipo	Cod.
Per 1 bobina	OBS001
Per 3 bobine	OBS003
Per 4 bobine	OBS004
Per 7 bobine	OBS007

Raccordi

Raccordi con cono 24° - Serie GAZ

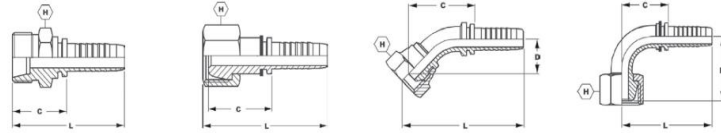

Ø tubo	Serie	Filetto	Raccordo dritto	Raccordo dritto	Raccordo 45°	Raccordo 90°
			Cod.	Cod.	Cod.	Cod.
1/4" - DN 06	13	20x150	PRF620	PGF620	PGF62045	PGF62090
5/16" - DN 08	13	20x150	PRF820	PGF820	PGF82045	PGF82090
	17	24x150	PRF817			
3/8" - DN 10	13	20x150	PRF1020	PGF1020	PGF102045	PGF82090
	17	24x150	PRF1024	PGF1024	PGF102445	PGF102490
1/2" - DN 13	13	20x150	PRF1320	PGF1320	PGF132045	PGF132090
	17	24x150	PRF1324	PGF1324	PGF132445	PGF132490
	21	30x150	PRF1321			
5/8" - DN16	17	24x150		PGF1624		
	21	30x150	PRF1630	PGF1630	PGF163045	PGF163090
3/4" - DN 19	21			PGF2030		
	27		PRF2036	PGF2036	PGF203645	
1" - DN25			PRF2545	PGF2545		

Raccordi con cono 24° - Serie leggera L

Ø tubo	Serie	Filetto	Raccordo dritto	Raccordo dritto	Raccordo 45°	Raccordo 90°
			Cod.	Cod.	Cod.	Cod.
3/16" - DN 05	6L	12x150	PR56	PGLO512	PGLO51245	PGLO51290
1/4" - DN 06	6L	12x150	PR66	PGLO612	PGLO61245	PGLO61290
	8L	14x150	PR68	PGLO614	PGLO61445	PGLO61490
	10L	16x150	PR610	PGLO616	PGLO61645	PGLO61690
	12L	18x150	PR612	PGLO618	PGLO61845	PGLO61890
5/16" - DN 08	8L	14x150	PR88	PGLO814	PGLO81445	PGLO81490
	10L	16x150	PR810	PGLO816	PGLO81645	PGLO81690
	12L	18x150	PR812	PGLO818	PGLO81845	PGLO81890
	15L	22x150	PR815	PGLO822		PGLO82290
3/8" - DN 10	10L	16x150	PR1010	PGLO1016	PGLO101645	PGLO101690
	12L	18x150	PR1012	PGLO1018	PGLO101845	PGLO101890
	15L	22x150	PR1015	PGLO1022	PGLO102245	PGLO102290
1/2" - DN 13	12L	18x150	PR1312	PGLO1318	PGLO131845	PGLO131890
	15L	22x150	PR1315	PGLO1322	PGLO132245	PGLO132290
	18L	26x150	PR1318	PGLO1326	PGLO132645	PGLO132690
5/8" - DN16	15L	22x150	PR1615	PGLO1622	PGLO162245	PGLO162290
	18L	26x150	PR1618	PGLO1626	PGLO162645	PGLO162690
	22L	30x200	PR1622	PGLO1630		PGLO163090
3/4" - DN 19	18L	26x150		PGLO2026	PGLO202645	PGLO202690
	22L	30x200	PR2022	PGLO2030	PGLO203045	PGLO203090
	28L	36x200		PGLO2036		PGLO203690
1" - DN25	28L	36x200	PR2528	PGLO2536	PGLO253645	PGLO253690
1"1/4 - DN 32	35L	45x200	PR3235	PGLO3245	PGLO324545	PGLO324590
1"1/2 - DN 40	42L	52x200	PR4042	PGLO4052	PGLO405245	PGLO405290

Raccordi con cono 24° - Serie forte S

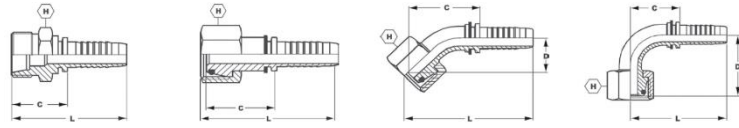

Ø tubo	Serie	Filetto	Raccordo dritto Cod.	Raccordo dritto Cod.	Raccordo 45° Cod.	Raccordo 90° Cod.
3/16" - DN 05	8S	16x150		PGSO516		
1/4" - DN 06	6S	14x150	PS66	PGSO614	PGSO61445	PGSO61490
	8S	16x150	PS68	PGSO616	PGSO61645	PGSO61690
	10S	18x150	PS610	PGSO618	PGSO61845	PGSO61890
	12S	20x150	PS612	PGSO620	PGSO62045	
5/16" - DN 08	10S	18x150	PS810	PGSO818	PGSO81845	PGSO81890
	12S	20x150	PS812	PGSO820	PGSO82045	PGSO82090
	16S	24x150		PGSO816		
3/8" - DN 10	10S	18x150	PS1010	PGSO1018	PGSO101845	PGSO101890
	12S	20x150	PS1012	PGSO1020	PGSO102045	PGSO102090
	14S	22x150	PS1014	PGSO1022	PGSO102245	PGSO102290
	16S	24x150	PS1016	PGSO1024		
1/2" - DN 13	12S	20x150		PGSO1320		
	14S	22x150	PS1314	PGSO1322	PGSO132245	PGSO132290
	16S	24x150	PS1316	PGSO1324	PGSO132445	PGSO132490
	20S	30x200	PS1320			
5/8" - DN16	16S	24x150		PGSO1624		PGSO162490
	20S	30x200	PS1620	PGSO1630	PGSO163045	PGSO163090
3/4" - DN 19	20S	30x200	PS2020	PGSO2030	PGSO203045	PGSO203090
	25S	36x200	PS2025	PGSO2036	PGSO203645	PGSO203690
1" - DN25	25S	36x200	PS2525	PGSO2536	PGSO253645	PGSO253690
	30S	42x200	PS2530	PGSO2542	PGSO254245	PGSO254290
1"1/4" - DN 32	38S	52x200	PS3238	PGSO3252	PGSO325245	PGSO325290

Raccordi doppi

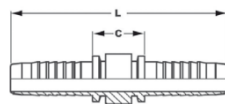

Ø tubo	Lung. (mm)	Cod.
3/16" - DN 05	66	PSVB55
1/4" - DN 06	72	PSVB66
5/16" - DN 08	72	PSVB88
3/8" - DN 10	76	PSVB1010
1/2" - DN 13	81	PSVB1313
5/8" - DN16	87	PSVB1616
3/4" - DN 19	98	PSVB2020
1" - DN25	128	PSVB2525

Raccordi BSP

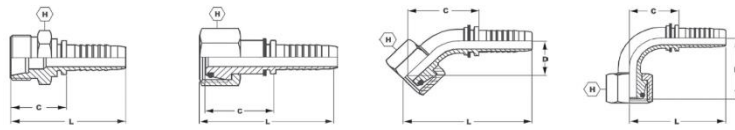

Ø tubo	Filetto	Raccordo dritto	Raccordo dritto	Raccordo 45°	Raccordo 90°
		Cod.	Cod.	Cod.	Cod.
3/16" - DN 05	BSP 1/8"	PN52	PF52	PF5245	PF5290
	BSP 1/4"	PN54	PF54	PF5445	PF5490
1/4" - DN 06	BSP 1/8"	PN62	PF62	PF6245	PF6290
	BSP 1/4"	PN64	PF64	PF6445	PF6490
	BSP 3/8"	PN66	PF66	PF6645	PF6690
	BSP 1/2"	PN68	PF68		PF6890
5/16" - DN 08	BSP 1/4"	PN84	PF84	PF8445	PF8490
	BSP 3/8"	PN86	PF86	PF8645	PF8690
	BSP 1/2"	PN88	PF88		PF8890
3/8" - DN 10	BSP 1/8"	PN102			
	BSP 1/4"	PN104	PF104	PF10445	PF10490
	BSP 3/8"	PN106	PF106	PF10645	PF10690
	BSP 1/2"	PN108	PF108	PF10845	PF10890
	BSP 3/4"	PN1012			
1/2" - DN 13	BSP 3/8"	PN136	PF136	PF13645	PF13690
	BSP 1/2"	PN138	PF138	PF13845	PF13890
	BSP 5/8"	PN1310	PF1310	PF131045	PF131090
	BSP 3/4"	PN1312	PF1312	PF131245	PF131290
5/8" - DN16	BSP 1/2"	PN168	PF168		PF16890
	BSP 5/8"	PN1610	PF1610	PF161045	PF161090
	BSP 3/4"	PN1612	PF1612	PF161245	PF161290
3/4" - DN 19	BSP 3/4"	PN2012	PF2012	PF201245	PF201290
	BSP 1"	PN2016	PF2016	PF201645	PF201690
1" - DN 25	BSP 1"	PN2516	PF2516	PF251645	PF251690
	BSP 1"1/4	PN2520	PF2520	PF252045	PF252090
1"1/4 - DN 32	BSP 1"1/4	PN3220	PF3220	PF322045	PF322090
	BSP 1"1/2		PF3224	PF322445	PF322490
1"1/2 - DN 40	BSP 1"1/2	PN4024	PF4024	PF402445	PF402490
	BSP 2"		PF4032	PF403245	PF403290
2" - DN 50	BSP 1"1/2	PN5024			
	BSP 2"	PN5032	PF5032	PF503245	PF503290

Raccordi JIC

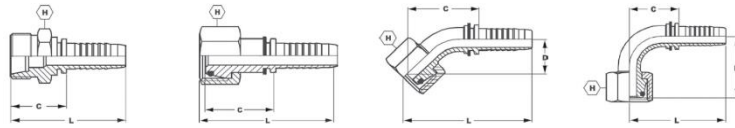

Ø tubo	Filetto	Raccordo dritto	Raccordo dritto	Raccordo 45°	Raccordo 90°
		Cod.	Cod.	Cod.	Cod.
3/16" - DN 05	UNF 7/16"	PC57	PA57	PA5745	PA5790
1/4" - DN 06	UNF 7/16"	PC67	PA67	PA6745	PA6790
	UNF 1/2"	PC68	PA68	PA6845	PA6890
	UNF 9/16"	PC69	PA69	PA6945	PA6990
5/16" - DN 08	UNF 1/2"	PC88	PA88	PA8845	PA8890
	UNF 9/16"	PC89	PA89	PA8945	PA8990
	UNF 3/4"	PC812	PA812	PA81245	PA81290
3/8" - DN 10	UNF 1/2"	PC108			
	UNF 9/16"	PC109	PA109	PA10945	PA10990
	UNF 5/8"	PC1010	PA1010	PA101045	PA101090
	UNF 3/4"	PC1012	PA1012	PA101245	PA101290
	UNF 7/8"	PC1014	PA1014	PA101445	PA101490
1/2" - DN 13	UNF 9/16"	PC139	PA139		
	UNF 3/4"	PC1312	PA1312	PA131245	PA131290
	UNF 7/8"	PC1314	PA1314	PA131445	PA131490
	UNF 1"1/16"	PC1317	PA1317	PA131745	PA131790
5/8" - DN 16	UNF 7/8"	PC1614	PA1614	PA161445	PA161490
	UNF 1"1/16"	PC1617	PA1617	PA161745	PA161790
	UNF 1"3/16"				PA161990
3/4" - DN 19	UNF 7/8"	PC2014	PA2014		
	UNF 1"1/16"	PC2017	PA2017	PA201745	PA201790
	UNF 1"3/16"	PC2019	PA2019	PA201945	PA201990
	UNF 1"5/16"	PC2021	PA2021	PA202145	PA202190
1" - DN 25	UNF 1"1/16"	PC2517	PA2517		PA251790
	UNF 1"3/16"		PA2519		
	UNF 1"5/16"	PC2521	PA2521	PA252145	PA252190
	UNF 1"5/8"	PC2526	PA2526	PA252645	
1"1/4" - DN 32	UNF 1"5/8"	PC3226	PA3226	PA322645	PA322690
	UNF 1"7/8"	PC3230			
1"1/2" - DN 40	UNF 1"7/8"	PC4030	PA4030	PA403045	PA403090
2" - DN 50	UNF 2"1/2"	PC5040	PA5040	PA504045	PA504090

Raccordi lisci metrici

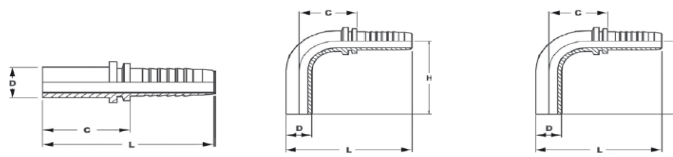

Ø tubo	Serie	Raccordo dritto	Raccordo 45°	Raccordo 90°
		Cod.	Cod.	Cod.
3/16" - DN 05	6L	PC57	PA5745	PA5790
	8L	PC67	PA6745	PA6790
1/4" - DN 06	6L	PC68	PA6845	PA6890
	8L	PC69	PA6945	PA6990
	10S	PC88	PA8845	PA8890
	12L	PC89	PA8945	PA8990
	12S	PC812	PA81245	PA81290
5/16" - DN 08	8L	PC108		
	10L	PC109	PA10945	PA10990
	12S	PC1010	PA101045	PA101090
	15L	PC1012	PA101245	PA101290
3/8" - DN 10	10L	PC1014	PA101445	PA101490
	12L	PC139		
	14S	PC1312	PA131245	PA131290
	15L	PC1314	PA131445	PA131490
1/2" - DN 13	12L	PC1317	PA131745	PA131790
	14S	PC1614	PA161445	PA161490
	15L	PC1617	PA161745	PA161790
	16S			PA161990
	18L	PC2014		
5/8" - DN 16	18L	PC2017	PA201745	PA201790
	20S	PC2019	PA201945	PA201990
	22L	PC2021	PA202145	PA202190
3/4" - DN 19	20S	PC2517		PA251790
	22L			
	25S	PC2521	PA252145	PA252190
1" - DN 25	28L	PC2526	PA252645	
	25S	PC3226	PA322645	PA322690
	30S	PC3230		
1"1/4 - DN 32	35L	PC4030	PA403045	PA403090
	38S	PC5040	PA504045	PA504090
1"1/2	42L	PT4042	PT404245	PT404290

Raccordi con flangia

Flangia SAE 3000 PSI

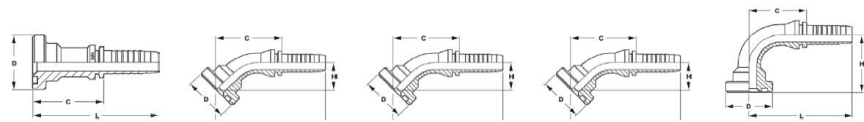

Ø tubo	Ø flangia (mm)	Raccordo dritto	Raccordo 30°	Raccordo 45°	Raccordo 60°	Raccordo 90°
		Cod.	Cod.	Cod.	Cod.	Cod.
1/2" - DN 13	30,2	PFL138		PFL13845		PFL13890
	38,1	PFL1312		PFL131245		PFL131290
	44,5			PFL131645		
5/8" - DN 16	30,2	PFL168		PFL16845		PFL16890
	38,1	PFL1612		PFL161245		PFL161290
3/4" - DN 19	38,1	PFL2012	PFL201230	PFL201245	PFL201260	PFL201290
	44,5	PFL2016	PFL201630	PFL201645	PFL201660	PFL201690
	50,8					PFL203290
1" - DN 25	38,1	PFL2512				PFL251290
	44,5	PFL2516	PFL251630	PFL251645	PFL251660	PFL251690
	50,8	PFL2520	PFL252030	PFL252045	PFL252060	PFL252090
1"1/4 - DN 32	44,5	PFL3216				
	50,8	PFL3220		PFL322045		PFL322090
	60,3	PFL3224	PFL322430	PFL322445		PFL322490
1"1/2 - DN 40	50,8	PFL4020				PFL402090
	60,3	PFL4024	PFL402430	PFL402445	PFL402460	PFL402490
	71,4	PFL4032	PFL403230	PFL403245		PFL403290
2" - DN 50	60,3					PFL502490
	71,4	PFL5032		PFL503245	PFL503260	PFL503290
	84,1	PFL5040				

Flangia SAE 6000 PSI

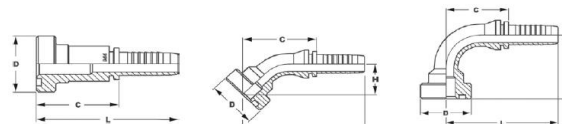

Ø tubo	Ø flangia (mm)	Raccordo dritto	Raccordo 45°	Raccordo 90°
		Cod.	Cod.	Cod.
1/2" - DN 13	31,7	PFS138	PFS13845	PFS13890
	41,3	PFS1312	PFS131245	PFS131290
5/8" - DN 16	31,7	PFS168	PFS16845	PFS16890
	41,3	PFS1612	PFS161245	PFS161290
	47,6	PFS1616	PFS161645	PFS161690
3/4" - DN 19	31,7			PFS20890
	41,3	PFS2012	PFS201245	PFS201290
	47,6	PFS2016	PFS201645	PFS201690
1" - DN 25	41,3	PFS2512	PFS251245	PFS251290
	47,6	PFS2516	PFS251645	PFS251690
	54	PFS2520	PFS252045	PFS252090
1"1/4 - DN 32	54	PFS3220	PFS322045	PFS322090
	63,5	PFS3224	PFS322445	PFS322490
1"1/2 - DN 40	63,5	PFS4024	PFS402445	PFS402490
	79,4	PFS4032	PFS403245	PFS403290
2" - DN50	79,4	PFS5032	PFS503245	PFS503290

Raccordi ORFS

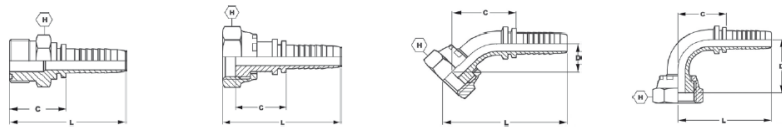

Ø tubo	Ø flangia (mm)	Raccordo dritto	Raccordo 30°	Raccordo 45°	Raccordo 60°
		Cod.	Cod.	Cod.	Cod.
1/4" - DN 06	9/16"	PCV69	PAV69	PAV6945	PAV6990
	11/16"	PCV611	PAV611	PAV61145	PAV61190
	13/16"		PAV613		
5/16" - DN 08	9/16"		PAV89	PAV8945	PAV8990
	11/16"	PCV811	PAV811	PAV81145	PAV81190
3/8" - DN 10	9/16"		PAV109		
	11/16"	PCV1011	PAV1011	PAV101145	PAV101190
	13/16"	PCV1013	PAV1013	PAV101345	PAV101390
	1"	PCV1016			
1/2" - DN 13	11/16"		PAV1311	PAV131145	PAV131190
	13/16"	PCV1313	PAV1313	PAV131345	PAV131390
	1"	PCV1316	PAV1316	PAV131645	PAV131690
	1"3/16"	PCV1319	PAV1319		
5/8" - DN 16	13/16"		PAV1613		
	1"	PCV1616	PAV1616	PAV161645	PAV161690
	1"3/16"	PCV1619	PAV1619	PAV161945	PAV161990
3/4" - DN 19	1"	PCV2016	PAV2016		PAV201690
	1"3/16"	PCV2019	PAV2019	PAV201945	PAV201990
	1"7/16"	PCV2023	PAV2023	PAV202345	PAV202390
1" - DN 25	1"3/16"	PCV2519	PAV2519		PAV251990
	1"7/16"	PCV2523	PAV2523	PAV252345	PAV252390
	1"11/16"	PCV2527	PAV2527	PAV252745	PAV252790
1"1/4" - DN 32	1"11/16"	PCV3227	PAV3227	PAV322745	PAV322790
1"1/2" - DN 40	2"		PAV4032	PAV403245	PAV403290

Raccordi a occhio con asola ad anello BSP

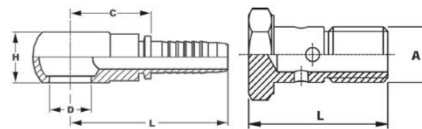

Ø tubo	Ø F (mm)	Cod.	Cod.
3/16" - DN 05	1/4"	PQB54	HBB04
1/4" - DN 06	1/8"	PQB62	HBB02
	1/4"	PQB64	HBB04
	3/8"	PQB66	HBB06
5/16" - DN 08	1/4"	PQB84	HBB04
	3/8"	PQB86	HBB06
3/8" - DN 10	1/4"	PQB104	HBB04
	3/8"	PQB106	HBB06
	1/2"	PQB108	HBB08
1/2" - DN 13	3/8"	PQB136	HBB06
	1/2"	PQB138	HBB08
5/8" - DN 16	5/8"	PQB1610	HBB10
3/4" - DN 19	3/4"	PQB2012	HBB12
1" - DN 25	1"	PQB2516	HBB16

Raccordi maschio filettatura esterna

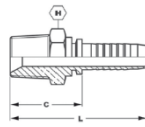

Ø tubo	Filetto	Cod.
1/4" - DN 06	1/8"	PNT62
	1/4"	PNT64
	3/8"	PNT66
	1/2"	PNT68
5/16" - DN 08	1/4"	PNT84
	3/8"	PNT86
	1/2"	PNT88
3/8" - DN 10	1/4"	PNT104
	3/8"	PNT106
	1/2"	PNT108
1/2" - DN 13	1/4"	PNT134
	3/8"	PNT136
	1/2"	PNT138
5/8" - DN 16	3/4"	PNT168
	1"	PNT1612
3/4" - DN 19	3/4"	PNT2012
	1"	PNT2016
1" DN 25	3/4"	PNT2512
	1"	PNT2516
1"1/4 - DN 32	1"	PNT3216
1"1/2 - DN 40	1"1/4	PNT3220
2" - DN 50	1"1/2	PNT4024
	2"	PNT5032

Raccordi maschio NPT

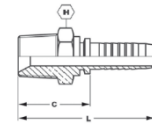

Ø tubo	Filetto	Cod.
3/16" - DN 05	1/8"	PE52
1/4" - DN 06	1/4"	PE54
	1/8"	PE62
	1/4"	PE64
	3/8"	PE66
	1/2"	PE68
5/16" - DN 08	1/4"	PE84
	3/8"	PE86
3/8" - DN 10	1/4"	PE104
	3/8"	PE106
1/2" - DN 13	1/2"	PE108
	1/4"	PE134
	3/8"	PE136
	1/2"	PE138
5/8" - DN 16	3/4"	PE1312
	1/2"	PE168
3/4" - DN 19	3/4"	PE1612
	1"	PE208
1" DN 25	1/2"	PE2012
	3/4"	PE2016
	1"	PE2512
1"1/4 - DN 32	1"	PE2516
	3/4"	PE2520
1"1/2 - DN 40	1"1/4	PE3220
2" - DN 50	1"1/2	PE4024
	2"	PE4032
	2"	PE5032

Raccordi zigrinato per idropultrici Femmina

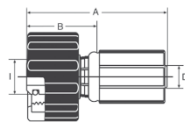

Ø tubo	Filetto	Cod.
1/4" - DN 06	22x150	HD260201
5/16" - DN 08	22x150	HD260202
3/8" - DN 10	22x150	HD260203

Maschio



Ø tubo	Ø F	Cod.
1/4" - DN 06	10	HD260206
5/16" - DN 08	10	HD260207